

Ball Spring Plungers With Slot

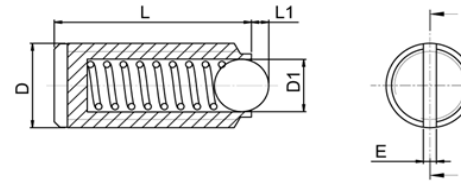

P1 = Spring Initial Loading kgf
 P2 = Spring Final Loading kgf

Ball Spring Plungers With Slot						
Diameter	D1	E	L	L1	Initial P1 (KGF)	Final P2 (KGF)
M3	1.5	0.4	7	0.5	0.15	0.31
M4	2.5	0.6	9	0.8	0.41	1.02
M5	3	0.8	12	0.9	0.61	1.12
M6	3.5	1	14	1	0.92	1.33
M8	5	1.2	16	1.5	1.53	3.06
M10	6	1.6	19	2	2.04	3.57
M12	8	2	22	2.5	3.06	5.61
M16	10	2.5	24	3.5	6.63	12.74
M20	12	2.5	30	4.5	8.16	16.32

Material : Steel
<i>Finish : Chemical Black</i>
<i>Stainless Steel</i>

INFORMATION AND DRAWINGS PROVIDED ARE FOR REFERENCE ONLY